

WAVE热浪

W10 蓝牙音箱

使用说明书

USER MANUAL

Table of Contents

01 - 07 English

08 - 14 简体中文

01 Precautions

English

- ◆ Please read the instruction first.
- ◆ Please follow the instruction carefully.
- ◆ Please store and use this product at room temperature.
- ◆ Do not use this product near heat sources such as radiators, heat registers, stoves, or other apparatus (including amplifiers) that produce heat.
- ◆ Do not block the opening of the speaker, and do not insert objects into the vents or slots of the speaker.
- ◆ Do not throw and drop the product to avoid damages.
- ◆ Please charge the speaker with product rated voltage.
- ◆ If the connection line does not match your device, please contact the dealer.
- ◆ Please keep volumes of the speaker mode rate to avoid temporary or permanent hearing impairment.
- ◆ No matter the equipment is damaged due to any reason, it must be repaired by professional maintenance personnel in time. Unauthorized disassembly will invalidate the warranty.
- ◆ If the battery is not properly replaced, there will be an explosion accident, which can only be replaced with the same type of battery.
- ◆ Do not disassemble, impact, squeeze or throw in to fire; If severe swelling occurs, do not continue to use; Do not place in a high temperature environment, do not use after the battery is soaked in water.
- ◆ Battery (battery pack or combined battery) can not be exposed to such conditions as sunshine, fire or similar over heating conditions.
- ◆ If consumers use a power adapter to charge, they should purchase a supporting power adapter that has obtained CCC certification and meets the standard requirements.

02 Packing Details

English

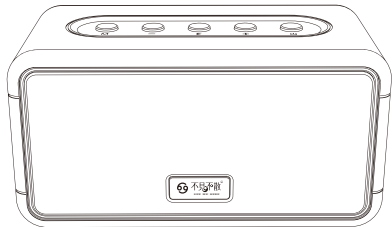

Speaker 1pc

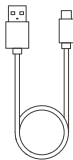

USB charging cable /
data cable 1pc

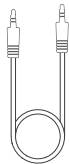

3.5mm audio cable 1pc



User manual 1pc

03 Button Function

English

Short press: Decrease the volume

Press and hold: Previous track

Bluetooth mode: The blue light quick flashes while the speaker is waiting for pairing. The light keeps while connected successfully.

TF card mode (Micro SD card): The green light keeps on
Aux mode: The Cyan light keeps on

Mode switch: Short press to switch the mode among Bluetooth/TF card/ Aux mode.

Bluetooth Mode: Press and hold 2 seconds to enter to the Bluetooth pairing mode. (Support two devices connected at the same time), press and hold 5 seconds to disconnect the Bluetooth and clear the paired list.

Play: Short press to play or pause

Short press: Increase the volume

Press and hold: Next track

Charging Indicator

The indicator will keep red while in charging and keep green while fully charged.

Power Indicator

Red indicator slowly flashes <10%
10%<=Red indicator <20%
20%<=Orange indicator <55%
55%<=Yellow indicator <75%
Green indicator >=75%

Power Button: Press and hold 2 seconds to power on/off

Reset: Press and hold 8 seconds to reset

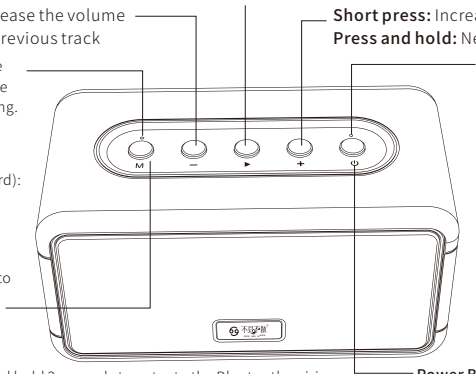

04 Interface Function

English

Charging:

Charge with a DC-5V 2A above USB adaptor or charge the device with a computer.

Data Transfer

Once the speaker connect to the computer by a data cable and insert a micro SD card at power-off status, then the music files can be copied and saved to the micro SD card.

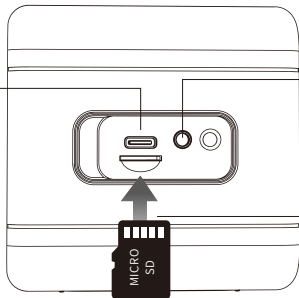

Aux Mode

The speaker will auto-switch to the Aux-in mode while connect with a aux cable.

Micro SD Playback

The speaker will auto-play the music stored in the micro SD card once micro SD card inserted.

05 Bluetooth Connection

English

1, Go to Bluetooth Pairing Mode

Power on the speaker, press and hold M button for 2 seconds to go to Bluetooth pairing mode, then the indicator of M button will flash quickly.

2, Connect with devices

Go to the Bluetooth list on your smart device and find "WAVE W10" to confirm connection .

You will hear the confirmation sound and the indicator of M button stays.

Tips:

01, Press and hold the M button for 5 seconds to disconnect with the current device and clear the paired list.

02, The speaker can connect with 2 smart devices at the same time.

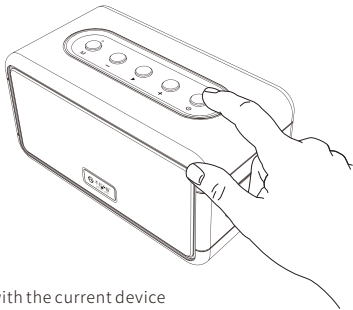

06 TWS Connection

English

1, The master speaker initiating connection

Power on one speaker and switch to Bluetooth mode, short press “V+” & “V-” at the same time ,the speaker will go to TWS mode and search the slave speaker after you hear a confirmation sound.



Master Speaker

2, The slave speaker initiating connection

Power on the slave speaker and switch to Bluetooth mode, press and hold M button for more than 5 seconds to disconnect with the smart phone and switch to the pairing mode, wait for the connection from the master speaker.



Slave Speaker

3,TWS connection

The master and slave speaker will connect successfully and with a confirmation sound. The indicator of the master speaker will indicate the Bluetooth status, the blue indicator of the slave speaker will stay.

4,TWS disconnection

Short press “V+” & “V-” at the same to disconnect from TWS mode.

Tips:

01, The master speaker is the left channel, the slave speaker is the right channel.

02, A TWS set only support 2pcs speakers.

03, Press the buttons on either speaker will have synchronous operation.

07 Technical Parameters

English

Basic Parameters	
Speaker Type	Bluetooth Speaker
Storage Type	Supports FAT/FAT32 format Micro SD card
Power Supply	Charge about 3 hours by using a DC5V-2A adaptor
Technical Parameters	
Speaker Unit	2*2.25 inch full-range speaker unit+ +130*56mm passive radiator
Frequency Response	65-20KHZ
Bluetooth Version	Bluetooth 5.3
USB	USB2.0,compatibleUSB1.1
Playing Function	
Format Support	MP3:8Kbps-320Kbps WMA:32Kbps-384Kbps WAV:32Kbps-1414Kbps

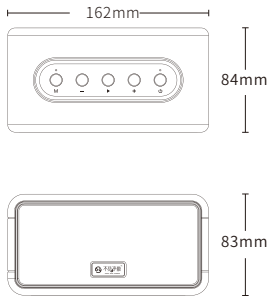

Product Size: 162 x 84 x 83mm

Product Weight: 700g (Built-in battery included)

08 注意事项

简体中文

- ◆请阅读本说明。
- ◆请遵循本说明。
- ◆请在常温环境中存放和使用本产品。
- ◆请勿在近热源处使用本产品，如散热器、热风调节器、炉灶或其他产生热量的仪器（包括放大器）。
- ◆请勿堵塞音箱的开口处，勿将物体塞入音箱的通风口或槽隙中。
- ◆请勿丢弃，避免因跌落造成本产品损坏。
- ◆请使用音箱额定电压的电源充电器充电。
- ◆如果连接线与您的设备不匹配，请与销售商联系。
- ◆请将音箱调至合适音量，避免对您的听力造成损害。
- ◆无论设备因何原因损坏，都必须及时请专业维修人员修理，擅自拆卸将使保修失效。
- ◆如果电池更换不当会有爆炸危险，只能用同样类型或等效类型的电池来更换。
- ◆禁止拆解、撞击、挤压或投入火中；若出现严重鼓胀，请勿继续使用；请勿置于高温环境中，电池浸水后禁止使用。
- ◆电池（电池包或组合电池）不得暴露在诸如日照、火烤或类似过热环境中。
- ◆消费者若使用电源适配器充电，则应购买配套使用获得CCC认证并满足标准要求的电源适配器。

09 包装清单

简体中文

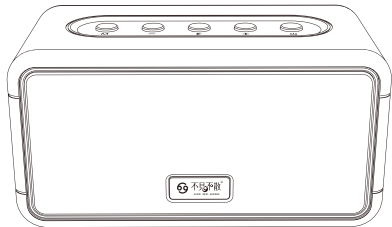

音箱主机 1台

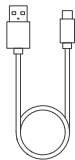

USB电源线/数据线 1条

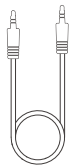

3.5mm音频线 1条



使用指南 1份

10 按键功能指示

简体中文

播放键：短按播放 / 暂停

短按：音量减小 长按：上一曲

短按：音量增大 长按：下一曲

蓝牙模式：蓝灯快闪，等待蓝牙配对，连接成功指示灯常亮

TF卡模式：绿色指示灯常亮

AUX模式：青色指示灯亮亮

模式切换：短按模式切换
蓝牙模式/TF卡模式/AUX切换
注：开机默认蓝牙模式

蓝牙模式：
长按2秒进入蓝牙配模式
(支持同时连接两台播放设备)
长按5秒断开蓝牙并清除配对列表

电源指示灯：
充电中红色常亮，充满绿色常亮

电量指示：
红色慢闪<10%
10%<=红色<20%
20%<=橙色<55%
55%<=黄色<75%
绿色>=75%

电源键：长按2秒开关机
系统复位：长按电源键8秒强制重启

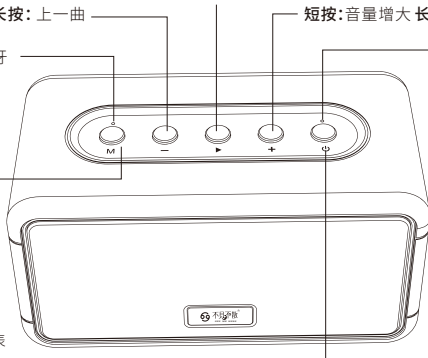

11 接口功能指示

简体中文

电源充电

连接DC5V~2A以上的USB电源适配器，或电脑USB端口充电

数据传输

关机状态下，音箱内已插入Micro SD卡，数据线连接电脑，即可拷贝音乐文件存入Micro SD存储卡

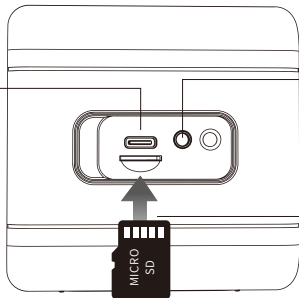

外接音源输入

连接音频线，音箱自动切换至外接音源模式

Micro SD播放

音箱开机状态插入Micro SD卡，音箱将自动播放Micro SD卡内的音乐文件

12 蓝牙音频连接

简体中文

1、进入蓝牙配对模式

音箱开机, 长按M键2秒进入蓝牙配模式, M键指示灯快闪, 等待蓝牙配对。

2、连接到移动设备

开启移动设备蓝牙选项, 在蓝牙设备列表中找到WAVE W10, 连接成功您将听到提示音, 同时M键指示灯常亮。

其它:

- 01、长按M键5秒断开蓝牙连接并清除配对列表
- 02、音箱支持同时连接两台播放设备

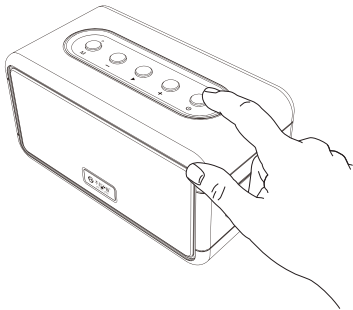

13 TWS无线串联功能

简体中文



主音箱



从音箱

1、主机TWS发起连接

选中一台音箱开机并切换到蓝牙模式，同时短按“音量+ - ”键，听到提示音后，音箱进入TWS串联模式，开始主动去搜索从机。

2、从机TWS连接

从机音箱开机并切换到蓝牙模式，断开手机链接，进入配对状态，等待TWS主机连接。

3、TWS连接成功

稍后主从机连接成功，并播报提示音，主机M键指示灯正常指示蓝牙模式状态，从机M键指示灯蓝灯常亮。

4、TWS断开操作

连接成功后，如需要退出TWS模式，同时短按“音量+ - ”键 即可退出。

其它说明：

01、主机为左声道，从音箱为右声道。

02、TWS无线串联，仅支持2个音箱设备无线串联。

03、无线串联成功后，操作任意一音箱功能按键，另一音箱同步相应操作。

14 技术参数

简体中文

基本参数	
音箱类型	蓝牙音箱
存储类型	支持FAT/FAT32格式 Micro SD卡
电源供应	DC5V-2A 以上的USB电源 充电约3小时左右
技术参数	
扬声器单元	2*2.25英寸全频扬声器+ 130*56mm被动低频辐射器
频率响应	65-20KHZ
无线连接	Bluetooth 5.3
USB规格	USB2.0、兼容USB1.1
播放功能	
文件格式	MP3:8Kbps-320Kbps WMA:32Kbps-384Kbps WAV:32Kbps-1414Kbps

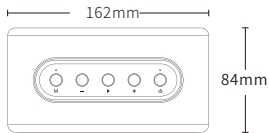

产品规格:162×84×83mm

产品净重:700g(含内置锂电池)



自助售后服务



不见不散公众号

生产企业:深圳市不见不散电子有限公司

地 址: 深圳市宝安区航空路32号-不见不散视听创新园

电 话: 0755-61181399 网 址: www.hb2099.com